

GROUND FLOOR

207 QUEEN STREET, OTTAWA, ON
 (ANSI/BOMA Z65.1-1996 LEASE AREA ANALYSIS PLAN)

COLOR LEGEND

- MAJOR VERTICAL PENETRATION
- OFFICE OR DESIGNATED STORAGE AREA
- STORE/RETAIL OR DESIGNATED STORAGE AREA
- BUILDING COMMON AREA
- FLOOR COMMON AREA



ORIENTATION

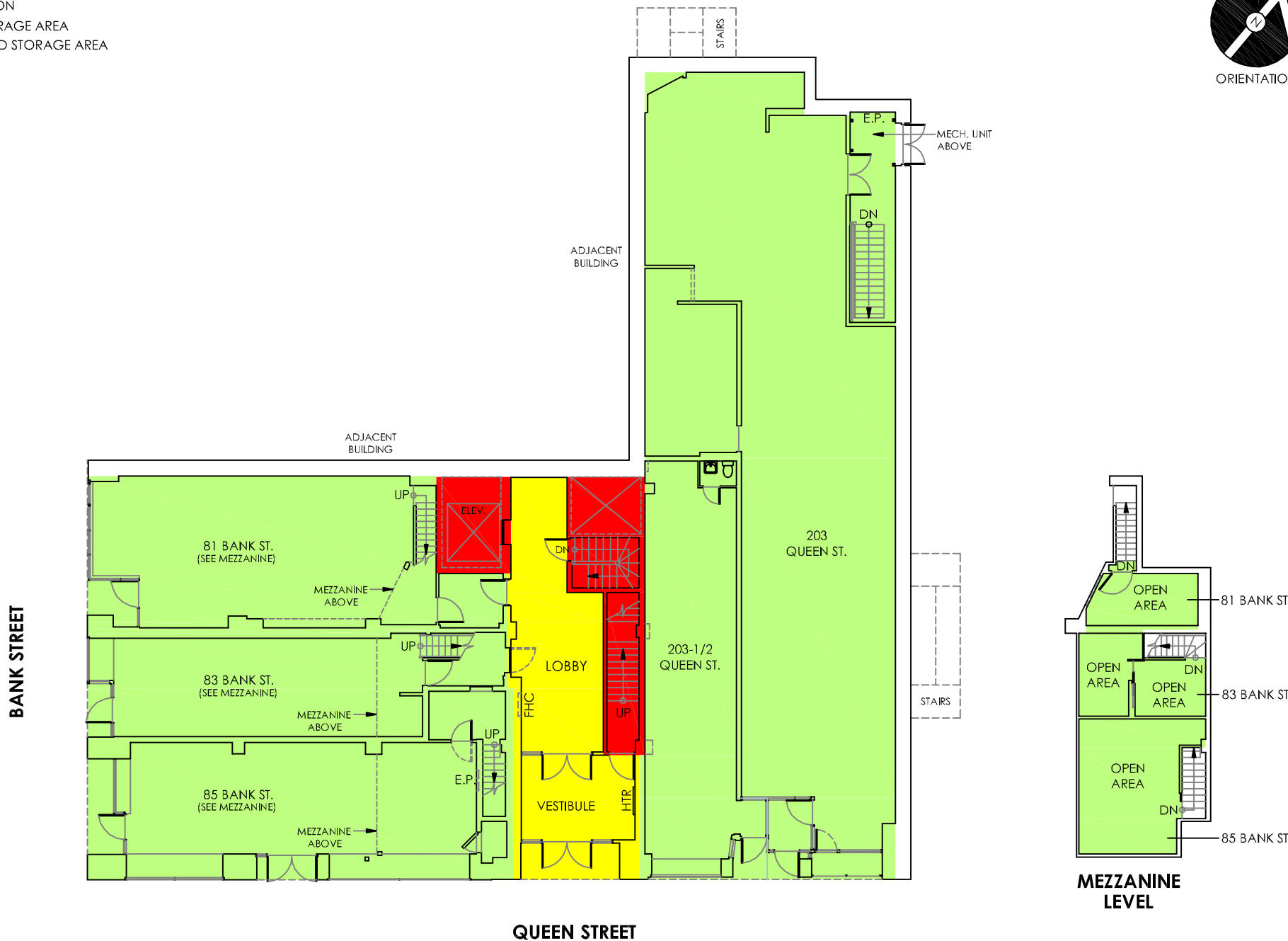

AREA CALCULATIONS:

FLOOR COMMON = N/A
 BUILDING COMMON = 552.543 S.F.*
 OFFICE USABLE = N/A

STORE USABLE (MEZZANINE INCL.):
 -81 BANK ST. = 865.544 S.F.* + 93.148 S.F.*
 = 958.692 S.F.*
 -83 BANK ST. = 602.883 S.F.* + 138.026 S.F.*
 = 740.909 S.F.*
 -85 BANK ST. = 947.414 S.F.* + 215.204 S.F.*
 = 1,162.618 S.F.*
 -203 QUEEN ST. = 2,311.655 S.F.*
 -203-1/2 QUEEN ST. = 626.584 S.F.*
TOTAL STORE USABLE = 5,800.457 S.F.*

MVP = 338.531 S.F.*
 GROSS BUILDING = N/A
 GROSS MEASURED = 6,691.532 S.F.*

PREPARED FOR: Toth Equity Ltd.
 ADDRESS: 381 Kent Street, Ottawa, ON
 DATE: October 28, 2009
 REVISION: November 26, 2009
 PROJECT NUMBER: 90046
 DRAWING SIZE: 8.5" x 14" - Legal Size

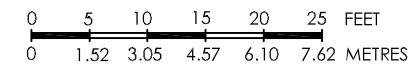

PREPARED BY: ECHOFLOORPLANS.COM

ECHO FLOOR PLANS
 ■ As-Built Floor Plans
 ■ Area Analysis
 ■ Space Planning
 www.ECHOFloorPlans.com